

REGULA HINGES WITH EXPOSED AXLE

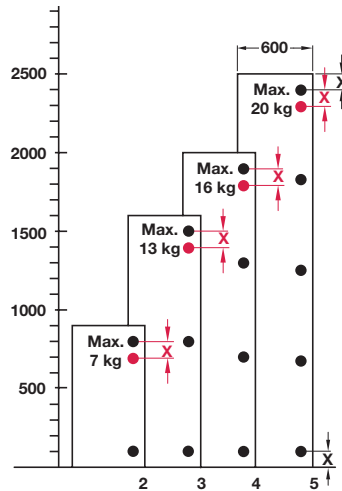
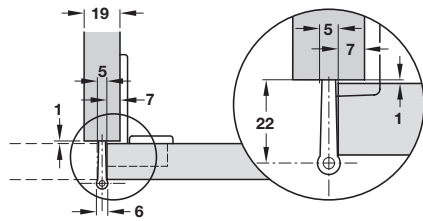

- > For door thickness 16 to 20 mm
- > With lateral adjustment up to 3 mm
- > With vertical adjustment ± 2 mm
- > With spring
- > Nickel-plated zinc alloy
- > Opening angle 180°

The hinge requirement is determined by the weight and the shape of the door
This table gives you a guideline for 19 mm chipboard
Doors must not be wider than they are high

Regula centre hinge with exposed axle, with pre-mounted dowels and screws

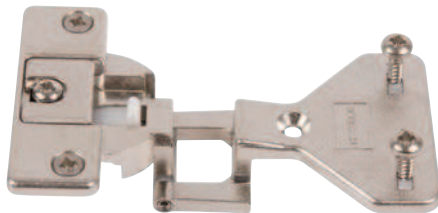

- > Centre panel mounting
- > Door fixing: Press-fit
- > Side panel fixing: Pre-mounted dowels and Hospa $\varnothing 3.5$ mm pan head screws, pre-mounted Varianta $\varnothing 5$ mm screws or Hospa $\varnothing 3.5$ mm pan head screws
- > 7 mm door overlay
- > Order qty: 1 pc

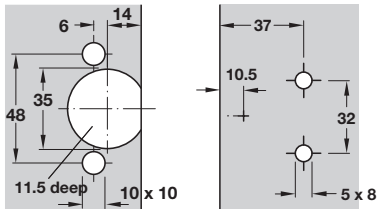

Centre panel fixing	Cat. No.
Pre-mounted dowels and screws	344.21.121

Regula centre hinge with exposed axle, Hospa screw fixing

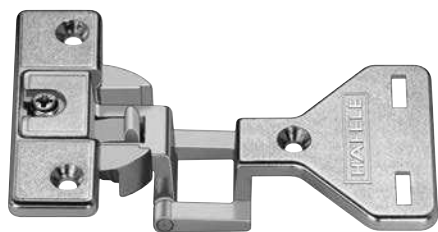

- > Centre panel mounting
- > Door fixing: Press-fit
- > Side panel fixing: Hospa $\varnothing 3.5$ mm pan head screws must be ordered separately
- > 7 mm door overlay
- > Order qty: 1 pc

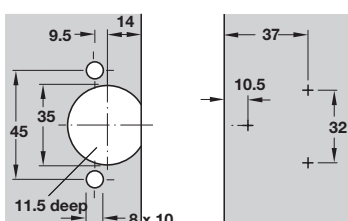

Centre panel fixing	Cat. No.
Hospa screws	344.21.201