

# INDICATOR BOLT FIXING INSTRUCTIONS - 19mm & 13mm Board

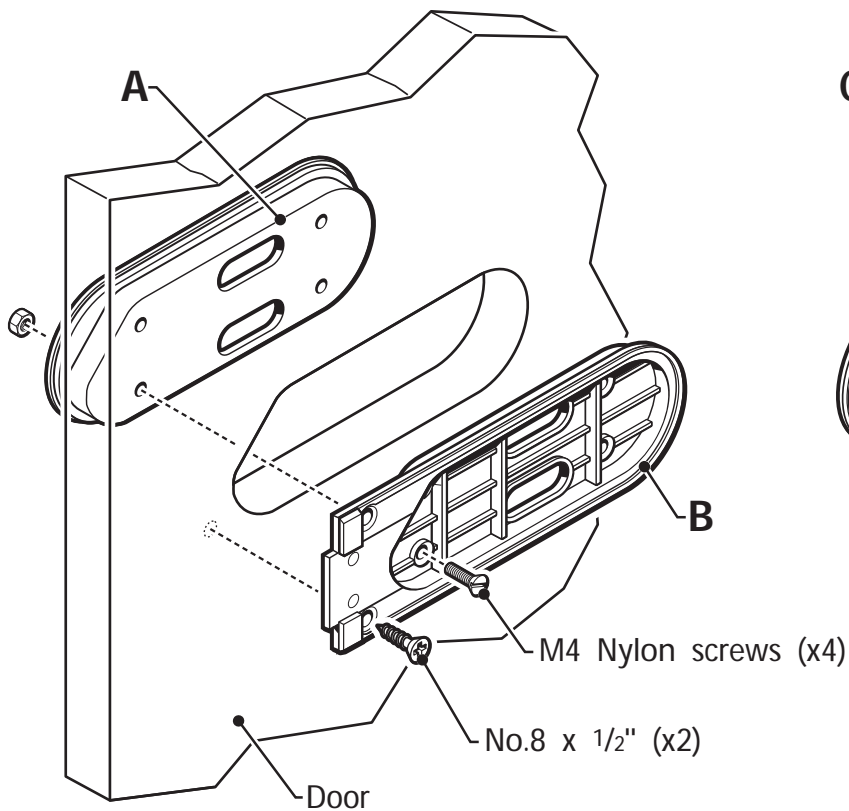

Fix white inner mouldings **A** & **B** either side of hole in door as shown. Fix with M4 nylon screws and nuts provided. Fix inner moulding **B** to door with No. 8 x 1/2" csk screws provided. For 13mm board use 3.5mm pilot drill.

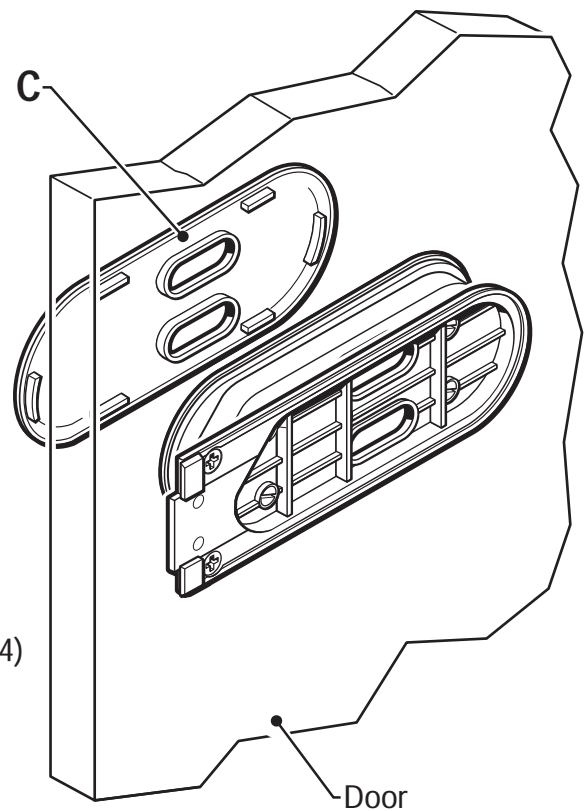

Snap coloured cover **C** to inner moulding **A** on inside of door ensuring oval holes align with inner moulding oval holes

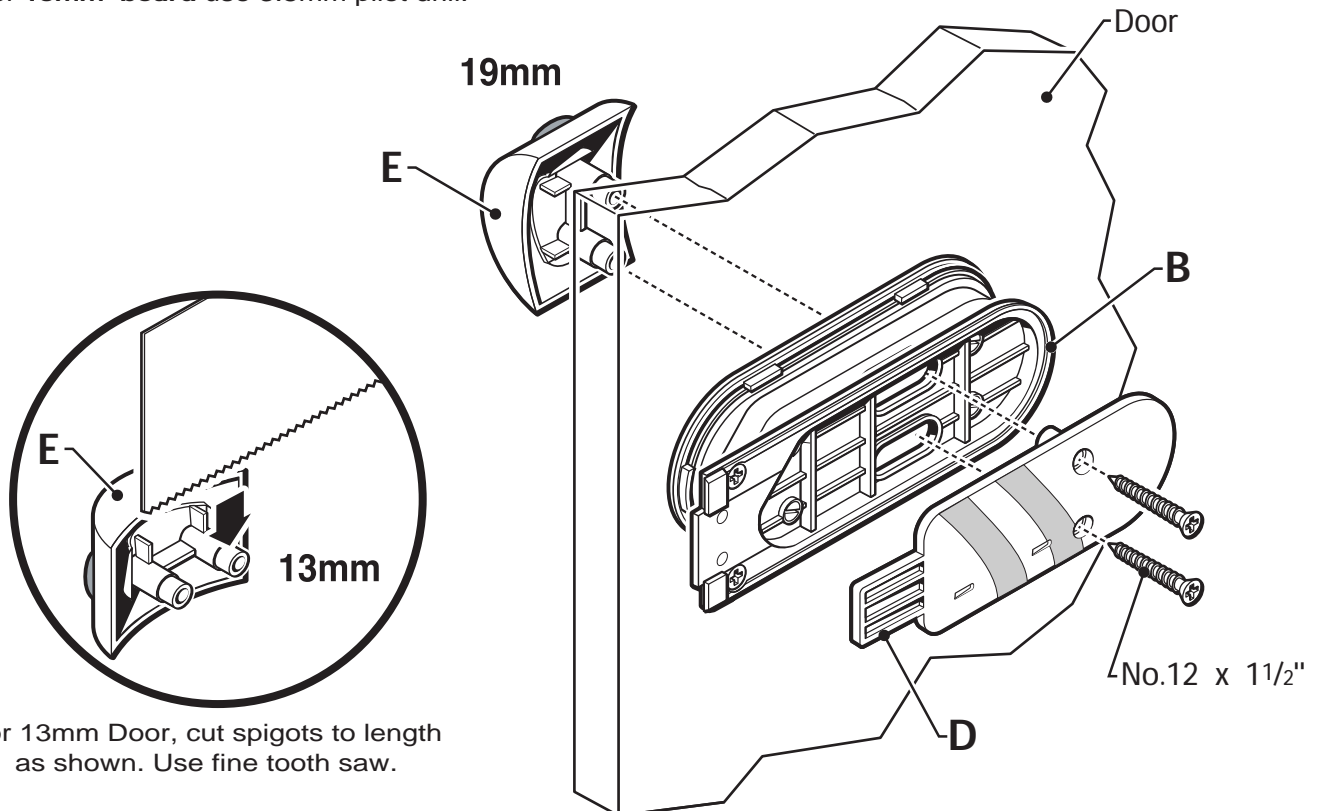

For 13mm Door, cut spigots to length as shown. Use fine tooth saw.

**armitage venesta**

Place red striped Shoot Bolt **D** in inner moulding **B**. Align coloured Handle **E** on reverse and fix through Shoot Bolt **D** using No. 12 x 1 1/2" csk screws provided. Do not over tighten. Ensure Shoot Bolt slides freely and easily in the moulding.

# INDICATOR BOLT FIXING INSTRUCTIONS - 19mm and 12.5mm Board

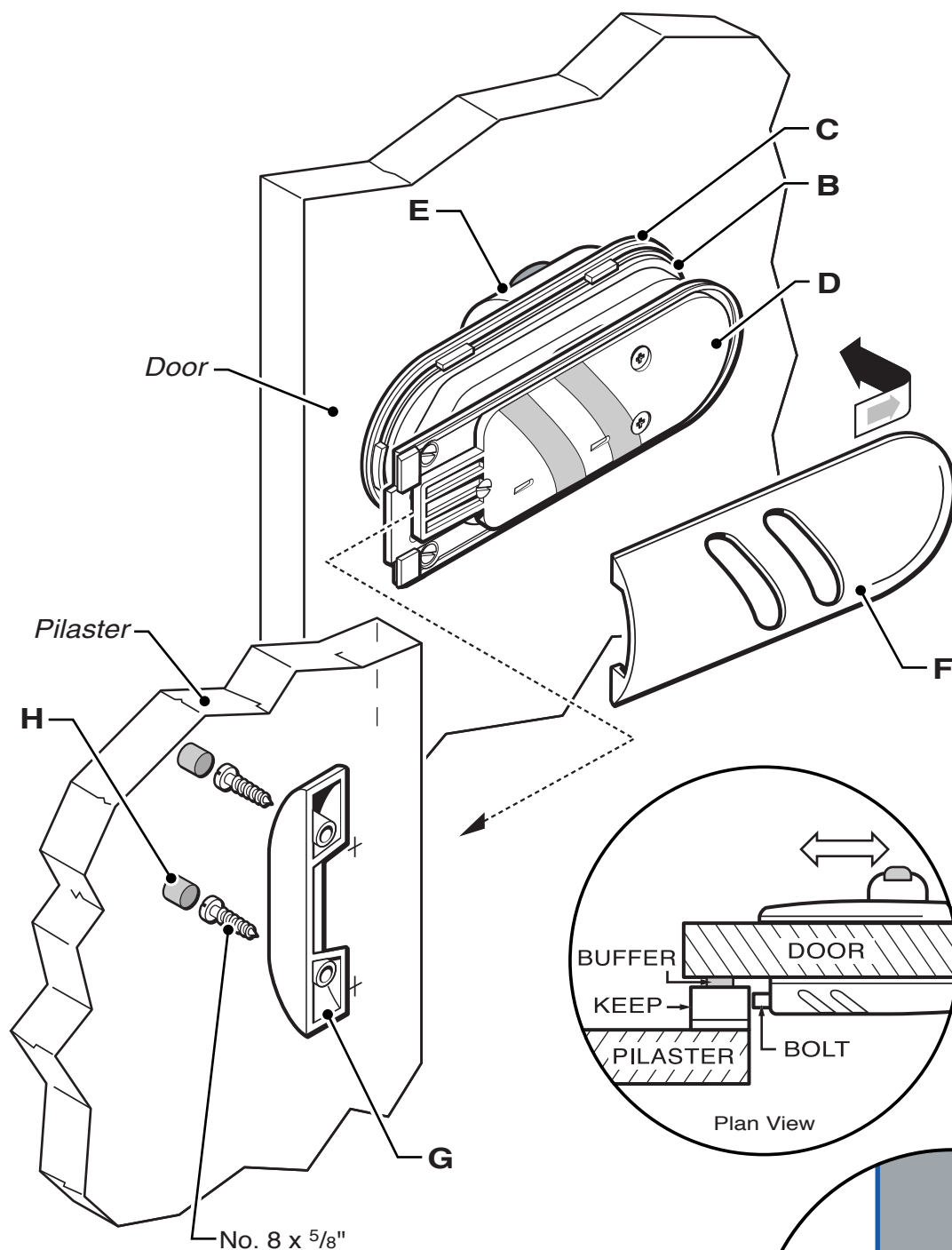

Slide Front Cover **F** over Shoot Bolt **D** (slide in from door edge), and snap onto inner moulding **B**.

Fix Keep **G** to Pilaster using 3.5mm pilot drill - **see right** and two No. 8 x  $\frac{5}{8}$ " pan head screws provided.

Insert Rubber Buffers **H** as shown.

## ESSENTIAL NOTES

Do not over tighten Handle **E** fixing screws.

Covers **C** & **F** can be permanently fixed by a careful application of pvc solvent weld to concealed surfaces.

Buffers **H** can be permanently fixed using Superglue (cyanoacrylate).

12.5mm door uses same indicator bolt as 19mm, but Handle **E** must be cut off at shoulder prior to installation, as shown.