

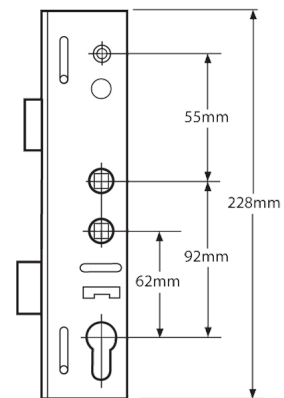

ASEC Lockmaster Copy Lever Operated Latch & Deadbolt Twin Spindle Gearbox



Description

This ASEC Lockmaster Copy Lever Operated Latch & Deadbolt Twin Spindle Gearbox is suitable for Lockmaster multipoint locks. The twin spindle gearbox is operated by lifting the lever to engage locking mechanisms and one full turn of the cylinder to lock, and one full turn of the key then push down on the lever to unlock. It is an ideal solution when the centre case gearbox is the only component which needs replacing within the locking mechanism. The gearbox is reversible and so suitable for both left handed and right handed applications.



35mm Backset



45mm Backset



92mm Centres



92/62mm Centres



Operated By Euro Cylinder



Reversible Handing

Features

- Latch & deadbolt
- Reversible to suit both left handed and right handed applications
- Twin spindle
- Centre gearbox only
- Euro profile lock case
- To suit Lockmaster
- Asec
- 0 g

Product Table



AS12095

35/92



AS12272

45mm 92/62