

Escape sash lock

D458

D458 escape sash lock

ASSA ABLOY

Application:

Escape sash locks are suitable for perimeter doors where single action escape is needed, but a high level of security is also required.

Available with single cylinder and thumbturn. Uses Euro profile cylinders.

Supplied as standard with striking plate. Both square and round faceplates are available.

Key can be removed in locked or unlocked position.

Split follower lock: incorporates different and separate functions on either side of the door.

For finishes, handing and dimensions see Lockcases Information appendix.

When ordering please specify door thickness.



Specification:

Double-throw stainless steel deadbolt thrown up to 20mm by two 360° turns of key or thumbturn.

Split follower lock; requires lever furniture with split spindles.

Both latchbolt and escape follower are reversible without opening lockcase.

Available with 60mm backset.

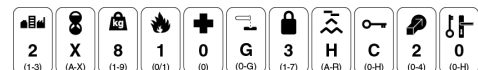

Exterior		Interior
Key operates deadbolt. Lever handle retracts latchbolt only.		Turn operates deadbolt. Lever handle retracts both deadbolt and latchbolt.

Finish:

Product has been successfully type-tested for conformity to BS EN 12209.

Regular audit testing is undertaken.

Product has also been successfully type-tested for conformity to BS EN 179 in conjunction with an ASSA Aluminium 1325 lever handle. Regular audit testing is undertaken. Classification: 3 7 6 B 1 4 4 2 A B/D.

D458 escape sash lock

Technical Design:

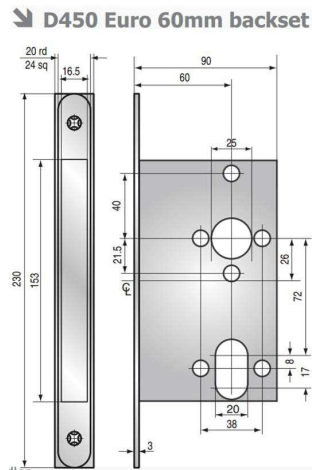

Code	Description
10440010131	D458 ESCAPE SASH 60MM SQU 24MM F/P
10439910131	D458 ESCAPE SASH 60MM RND 20MM F/P