

8 7 6 5 4 3 2 1

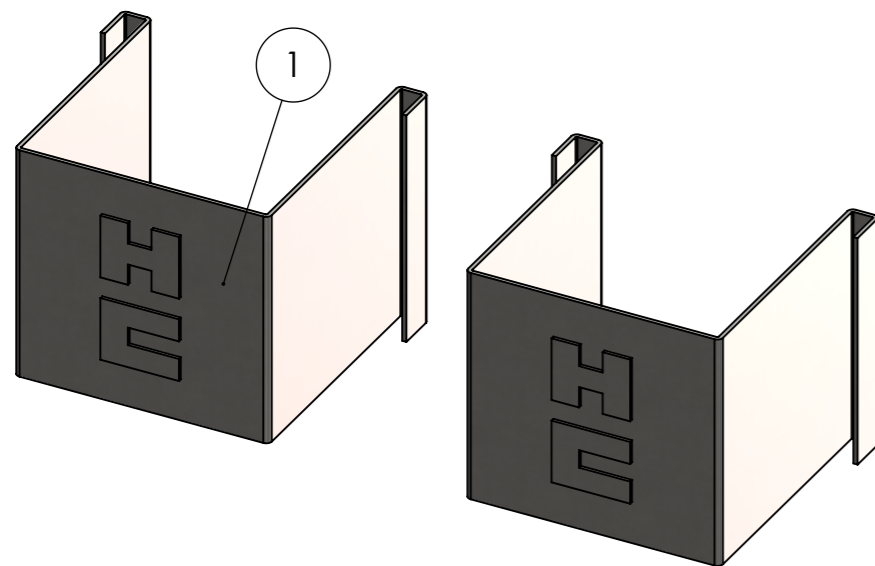
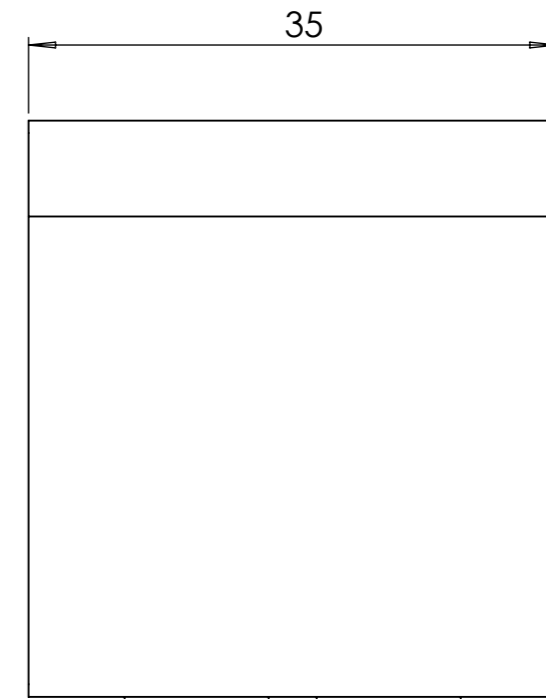
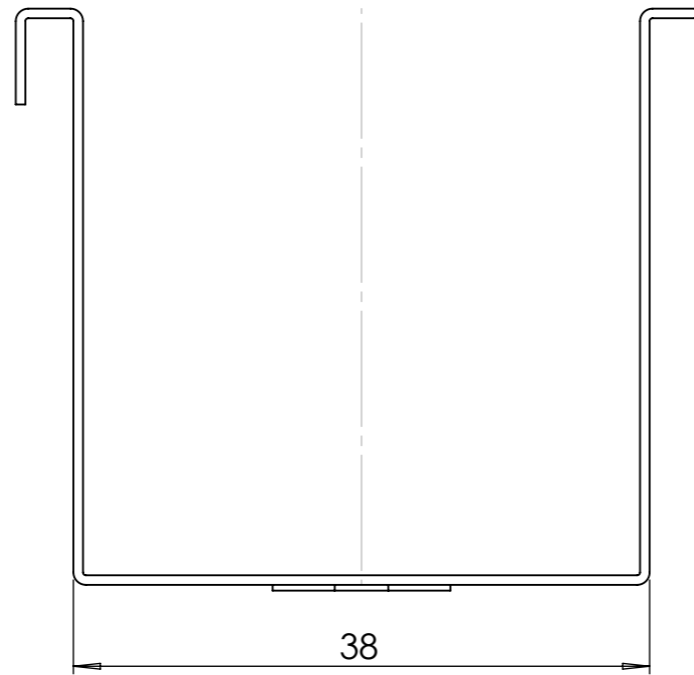
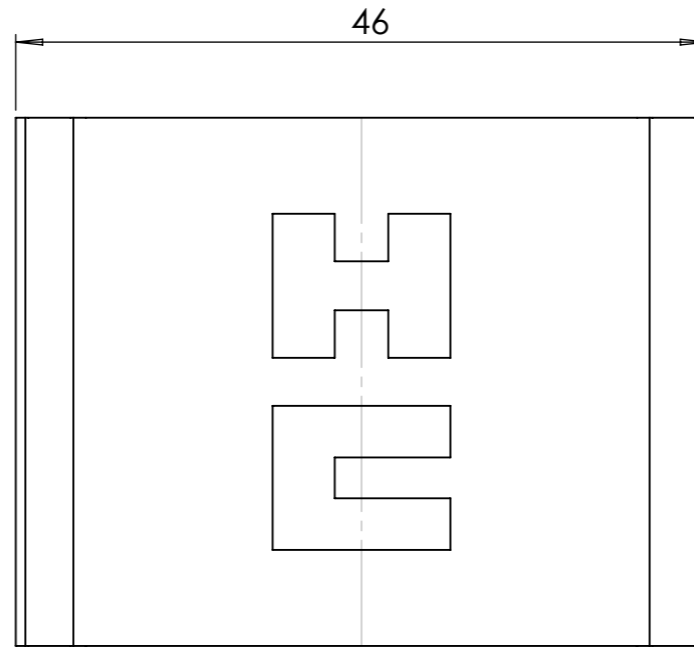

ITEM NO.	PART NUMBER	DESCRIPTION	QTY.
1	02051.01	CLOSED END PIECE - Rev.01	2

<b>COBURN SLIDING SYSTEMS LIMITED</b> Unit 1, Cardinal west, Godmanchester, PE29 2XN United Kingdom TEL: +44 (0)20 8545 6680 FAX: +44 (0)20 8545 6720 E-Mail: sales@coburn.co.uk Web: www.coburn.co.uk	UNLESS OTHERWISE SPECIFIED: <b>DIMENSION(mm) TOLERANCE</b> ZERO PL DECIMAL ±0.2 ONE PL DECIMAL ±0.1 TWO PL DECIMAL ±0.05 ANGULAR TOLERANCE ±0.5° FORGING TOLERANCE SEE BS EN 10243 ALL EDGES WILL BE ROUNDED WITH 0.2mm	MATERIAL	DRAWN by: Adrian BOGDAN	DRAWING TYPE Final part drawing	
		FINISH	CHECKED by: -	TITLE: CLOSED END PIECE FOR 2-16 TRACK PACK	
© COPYRIGHT COBURN SLIDING SYSTEMS LIMITED THE INFORMATION CONTAINED IN THIS DRAWING IS THE SOLE PROPERTY OF <COBURN SLIDING SYSTEMS LIMITED>. ANY REPRODUCTION IN PART OR AS A WHOLE WITHOUT THE WRITTEN PERMISSION OF <COBURN SLIDING SYSTEMS LIMITED> IS PROHIBITED.	COMMENTS: IF IN DOUBT ASK!	FIRST ANGLE PROJECTION	SIZE A3	DWG NO. 02051	REV. 01
			SCALE: 1:1	WEIGHT:	SHEET 1 / 1

8 7 6 5 4 3 2 1

F  
E  
D  
C  
B  
A

F  
E  
D  
C  
B  
A