

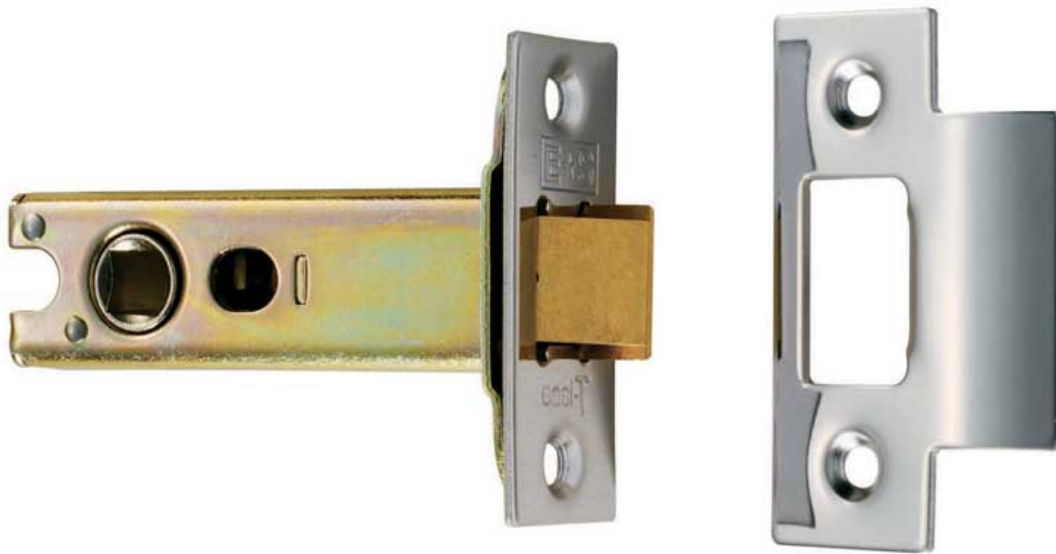

## Easi-T Heavy Sprung Tubular Latch

### Product Images

---



### Description

---

Heavy Sprung Tubular Latch, available in various sizes. Commonly used to assist unsprung handles return to level. Certified to BS EN 12209. This latch

carries a 10 year mechanical guarantee. It has been CE and Certifire tested. Suitable for use in all domestic, industrial and commercial environments.

Technical Details

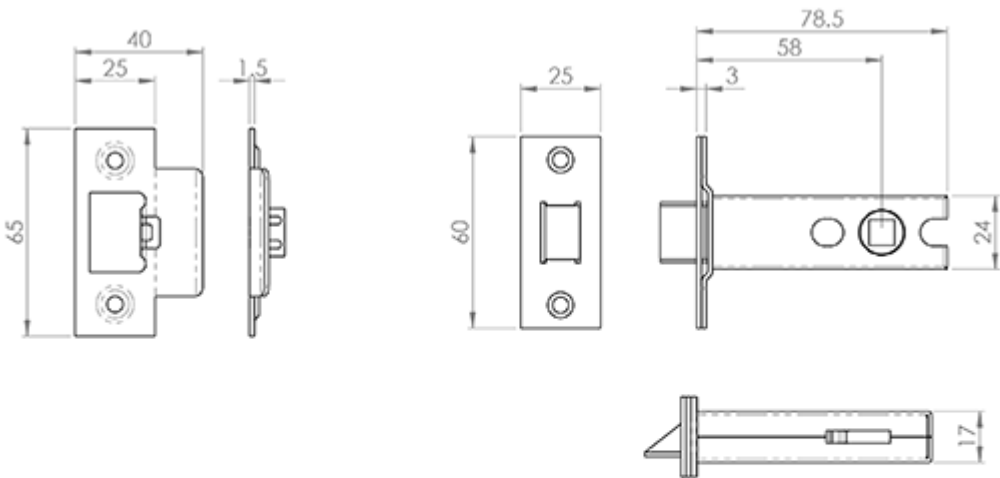

TLS5030

This drawing is the property of Carlisle Brass Limited, all design rights reserved

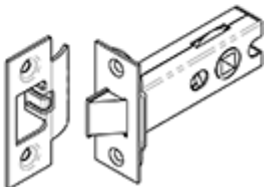

Specification



Additional Information

Short Description	Heavy Sprung Tubular Latch
SKU	TLS5025
Certifire	CF611
Standard	EN12209
CE Marked	Yes
Brands	Eurospec
Technical	4,20,26,21,22
Line Drawings	TLS5025.jpg,TLS5030.PDF,TLS5040.PDF,TLS5050.jpg

Product Options

Finishes:	Bright Stainless Steel
	Satin Stainless Steel
	Electro Brassed/Satin Stainless Steel
	Bright/Satin Stainless Steel
Sizes:	76mm
	64mm
	127mm
	103.5mm
Options:	Radius
	Square

